

# BERMAN ENDODONTICS, LLC



**Svetlana Berman, D.D.S., M.S.D.**  
American Association of Endodontists specialist member

Referred by Dr. \_\_\_\_\_

Introducing my patient \_\_\_\_\_

Appointment date \_\_\_\_\_

	Molars		Biscupids		Anteriors		Anteriors		Biscupids		Molars						
<i>right</i>	1	2	3	4	5	6	7	8	9	10	11	12	13	14	15	16	<i>upper</i>
	32	31	30	29	28	27	26	25	24	23	22	21	20	19	18	17	<i>lower</i>
<i>left</i>																	

(circle teeth for endodontic consideration)

- Patient has pain, swelling or sensitivity  
Please evaluate and treat.
- Endodontics necessary for restoration.
- Pulp was exposed.
- Tooth has been opened.
- X-ray revealed a radiolucency.
- X-ray revealed pulpal involvement.
- Please evaluate for periapical surgery or  
retreatment.
- Post space.

Remarks: \_\_\_\_\_

704 Adams Street, Suite D • Carmel, IN 46032

Phone: (317) 815-5552 • Fax (317) 815-5571

sberman@iupui.edu • www.bermanendodontics.com

*map on back*

# Berman Endodontics, LLC

704 Adams Street, Suite D  
Carmel, IN 46032

## From the North:

Take Meridian St. south to 126th/W. Carmel Dr. and on that light turn left to W. Carmel Dr.; shortly after 2nd light turn left to Adams Street and immediately left into the Park Place Plaza and then turn right and drive straight to the very back building.

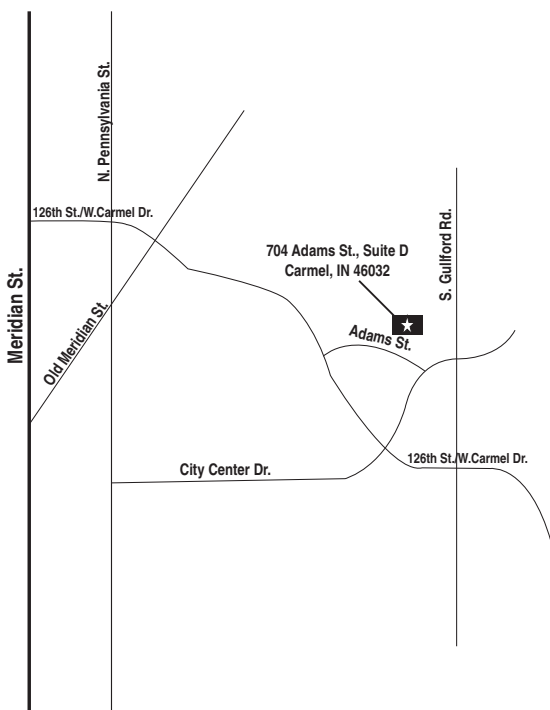

## From the South:

Take 465 to exit #31/Meridian Street, take Meridian Street north to 126th/W. Carmel Dr. and on that light turn right to W. Carmel Dr.; shortly after 2nd light turn left to Adams Street and immediately left into the Park Place Plaza and then turn right and drive straight to the very back building.